

**DMH**  
SOLUTIONS FOR SEALS



**DMH**

**500**

# THE BEST SELLER. A REAL JACK-OF- ALL-TRADES.

The DMH 500 is suited to seals with a turning diameter of up to 500 mm, is characterized by its simple structure, and is the most frequently used around the world – which is thanks not least to its reliable and universal application. The DMH 500 models are especially suited to elastomers because their programming and turning technology were specifically optimized for these.

**Application areas:**

- Seal retailers
- OEM (with model H)
- Hydraulic repair shops
- MRO
- Mobile hydraulics
- Heavy hydraulics

**Equipment options:**

The machine is available in the versions M (manual) and H (hydraulic).

**Scope of delivery:**

Included in the purchase are software, basic tool kit, clamping system, chopper, and suction system.



DETAILS

DMH 500 M

DMH 500 H

Max. turning diameter	500 mm	500 mm
Main drive power	7 kW	9 kW
Total weight	3,300 kg	3,300 kg
Dimensions (L × W × H)	2,575 × 1,790 × 2,060 mm	2,575 × 1,790 × 2,060 mm
Max. bar diameter	45 mm	45 mm/BB 51 mm
Slide traverse X/Y/Z	240/-/510 mm	240/-/510 mm
y-axis	no	no
c-axis	no	no
Max. speed, main drive	6,300 1/min.	6,300 1/min.
Spindle nose per DIN 55026	A 2-5	A 2-5
Power input	20 kVA	20 kVA
Tool size	VDI 20	VDI 20
Turret positions	8	8
Rapid traverse X/Y/Z	24/-/30 m/min.	24/-/30 m/min.
Control	Siemens/Fanuc	Siemens/Fanuc
Barfeeder interface	no	optional

ADD-ONS



# DMH 500

## H

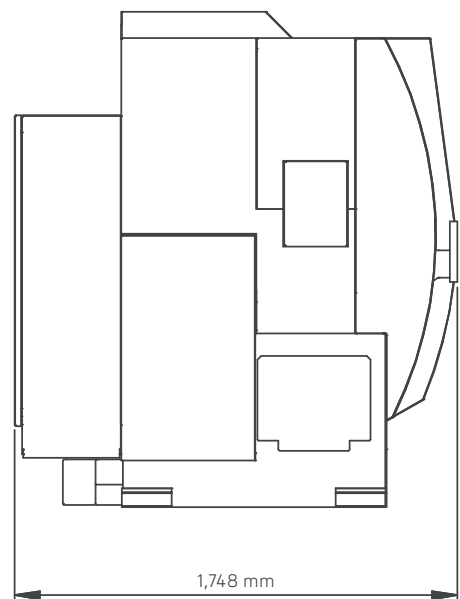
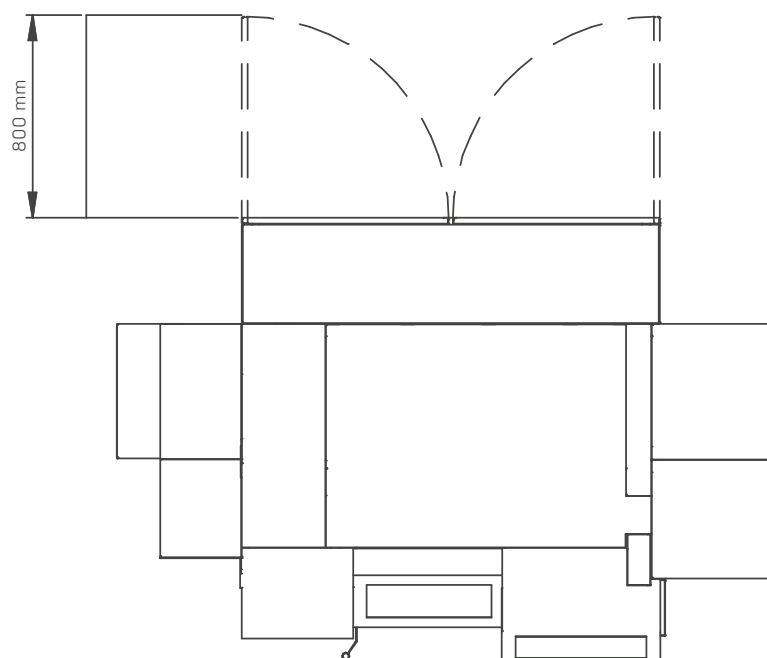
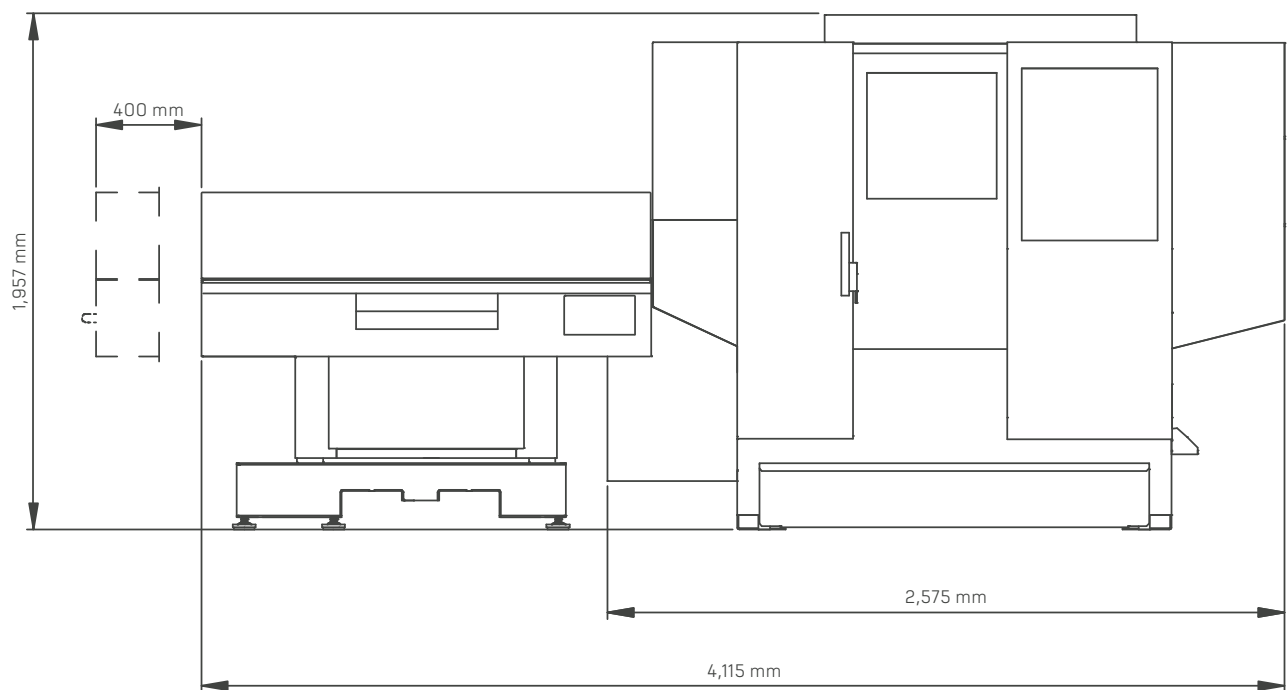

# DMH 500

## M

